

FUEL TANK

SCHEMATIC DRAWING ----- 15-1
SERVICE INFORMATION ----- 15-2
TROUBLESHOOTING ----- 15-2
FUEL TANK REMOVAL ----- 15-3
FUEL STRAINER INSPECTION ----- 15-3

15. FUEL TANK

SCHEMATIC DRAWING

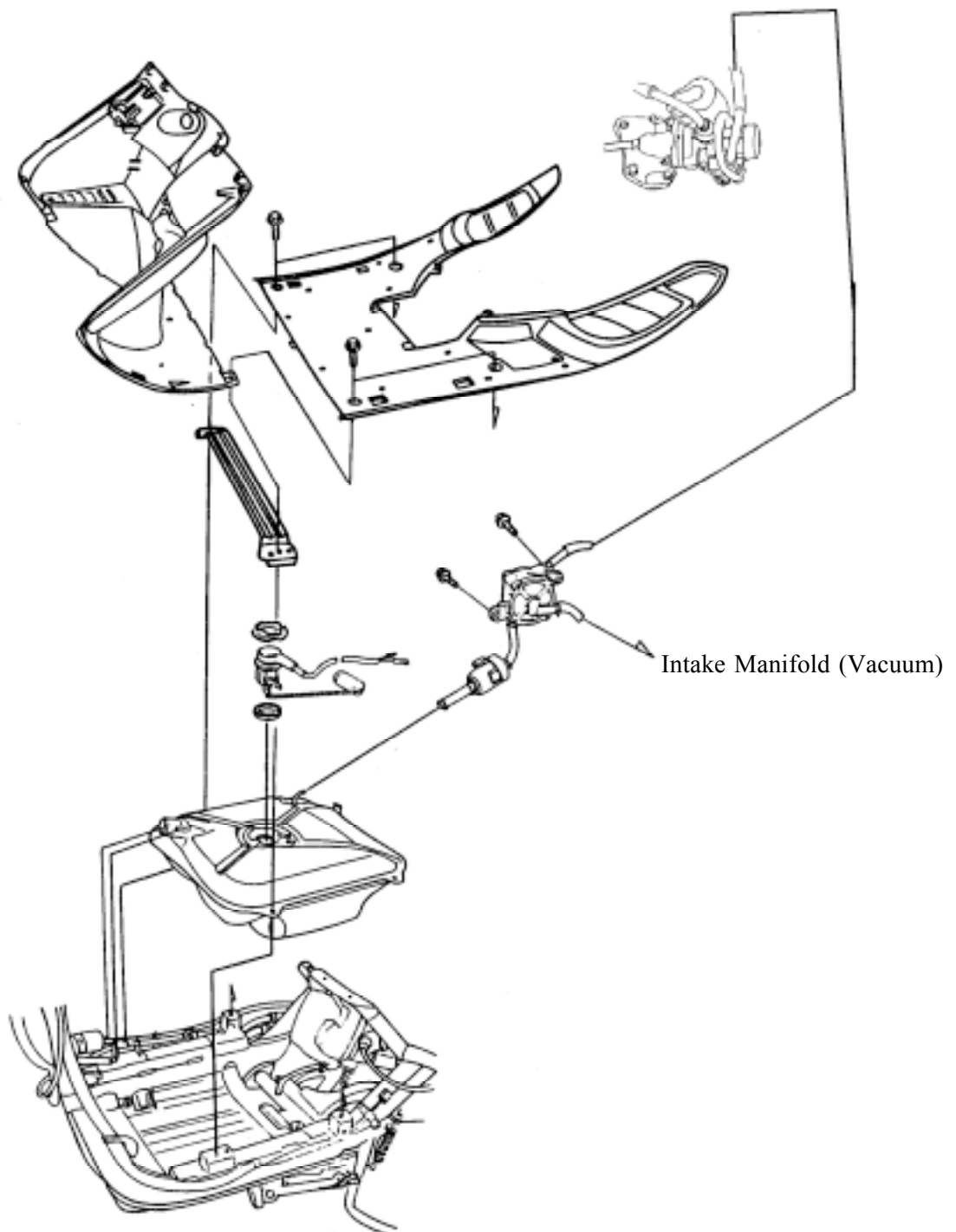

15. FUEL TANK

SERVICE INFORMATION

GENERAL INSTRUCTIONS

- When removing the fuel tank, keep sparks and flames away from the working area.
- When removing the fuel tank, the remaining fuel in the tank must be lower than __ of the fuel tank capacity to avoid gasoline overflowing.
- Fuel tank capacity: 10 liters

TROUBLESHOOTING

Engine is hard to start

- No fuel in tank
- Restricted fuel line
- Clogged fuel strainer
- Faulty fuel pump
- Broken or clogged vacuum tube
- Faulty or clogged charcoal canister

Lean mixture

- Clogged charcoal canister
- Bent, kinked or restricted fuel line
- Clogged fuel strainer
- Float level too low

15. FUEL TANK

FUEL TANK REMOVAL

Remove the floor board. (⇒2-4)
Remove the leg shield. (⇒2-5)
Disconnect the fuel unit wire connector.
Remove the fuel tube between the fuel tank and the fuel filler.
Disconnect the fuel vapor tube.
Remove the fuel tank.

The installation sequence is the reverse of removal.

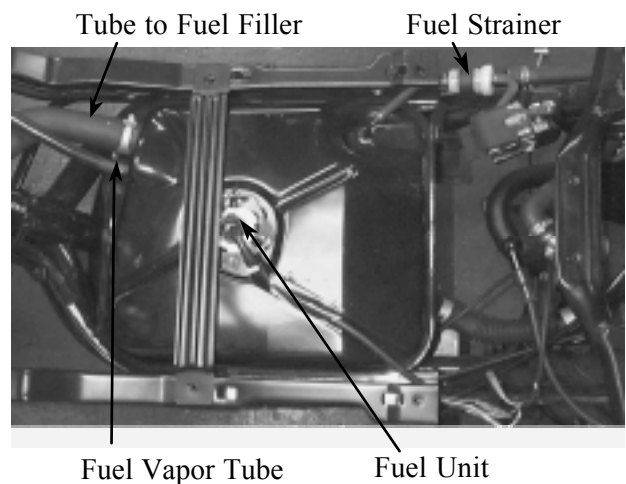

FUEL STRAINER REMOVAL

Remove the fuel strainer from the fuel tank.

INSPECTION

Inspect if the fuel strainer is clogged and clean it with compressed air.

- * When removing the fuel strainer, do not allow flames or sparks near the working area and drain the residual gasoline into a container.



INSTALLATION

Install the fuel strainer with its arrow mark toward the fuel pump.

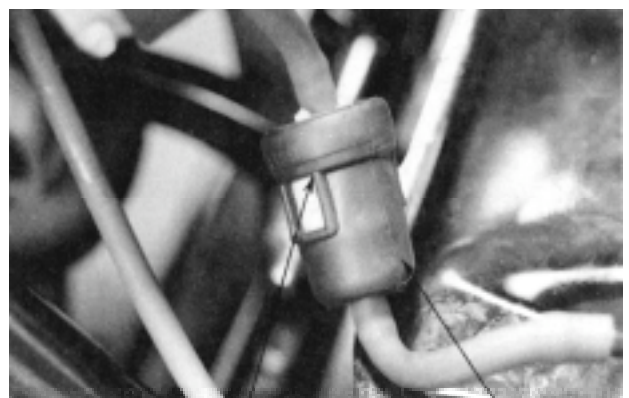

Arrow Mark

Fuel Strainer